



MINERAL WOOL CORE WALL SANDWICH PANELS WITH EXPOSED FASTENING



MW-W-ST

FEATURES

- **FIRESTOP** – high fire tightness - unique, both-sided shape of the panel-and-lock joint
- high fire resistance - can be used as fire divisions
- high thermal insulating power - well fitted joint
- **SUPERIOR GASKET** – maximum tightness of the joint and easier assembly owing to application during the production process of an EPDM gasket in internal or both sides of the joint - **NEW!**
- easy assembly - profiling of the lock and conical sloping of the internal joint surface matches the BALEX THERM-W-ST panels with various core materials
- high strength - mineral wool core specially prefabricated in-line
- high durability of anti-corrosion coatings - appropriate technology for profiling the shape of metal facing
- aesthetic façade appearance - wide range of profiles and colours of external facing

APPLICATION

- exterior walls
- partition walls
- interior flooring covering
- structure insulation
- commercial and industrial facilities of elevated fire-resistance requirements
- logistic facilities
- office facilities
- agricultural facilities
- fruit and vegetable stores
- sport halls



TECHNICAL PARAMETERS

Name	Mineral wool core wall sandwich panels with exposed fastening - BALEXTHERM-MW-W-ST									
Core	hard mineral wool (nominal apparent density 110 kg/m³)									
Facing thickness [mm]	0,50 – 0,70									
Steel grade	S250GD									
Coatings	SP polyester, matt pearl SP polyester, matt HDP polyester, PVC(F) „foodsafe“, PVDF, galvanized, alu-zinc + easyfilm®, CESAR PUR 55* - a polyurethane coating with polyamide balls, superior life & durability									
Colouring	wide range of Balex Metal World of Colours -									
Effective width [mm]	1100									
Total width [mm]	1120									
Panel length [mm]	2 500 – 15 000									
Core thickness [mm]	80	100	120	130	140	150	160	180	200	230
Panel weight [kg/m²]	17,79	19,80	21,90	23,00	24,00	25,01	26,10	28,20	30,30	33,50
Thermal transmittance U _c [W/m²K]	0,47	0,38	0,32	0,30*	0,28	0,26	0,24	0,22	0,19	0,17
Fire resistance	NRO**	Not spreading fire NRO, EI 60				Not spreading fire NRO, EI 240				
Reaction to fire	A2-s1.d0									

* The BALEX THERM-MW-W-ST panel with 130 mm thick core meets the minimal requirements related to the heat transfer coefficient for walls specified in the Ordinance of the Minister of Infrastructure

** Not spreading fire NRO

NEW!

TYPES OF FACING PROFILES

L Lined



M Microprofiled



R Grooving



G Flat



AVAILABLE TYPES OF FACING PROFILES

External facing

L **M** **R** **G***

Internal facing

L **G***

* available with facing of minimal thickness 0.60mm

SECTIONAL VIEW OF THE BALEXTHERM-MW-W-ST PANEL

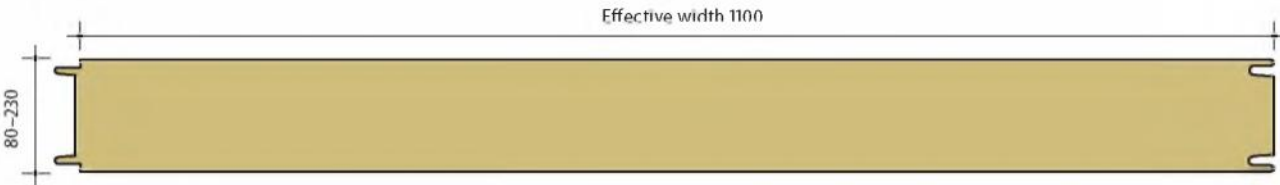

DETAILS OF THE BALEXTHERM-MW-W-ST PANELS JOINT

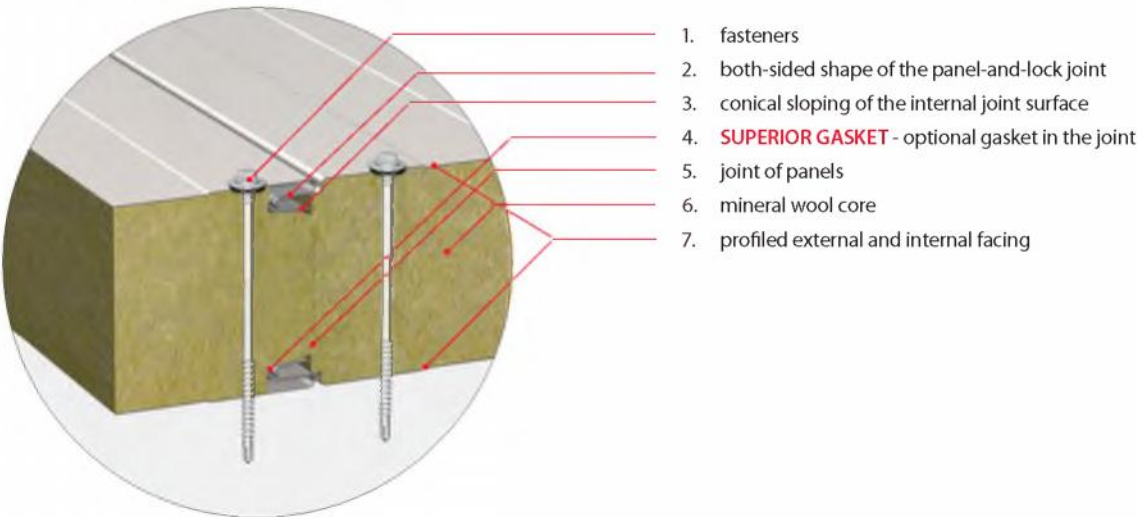

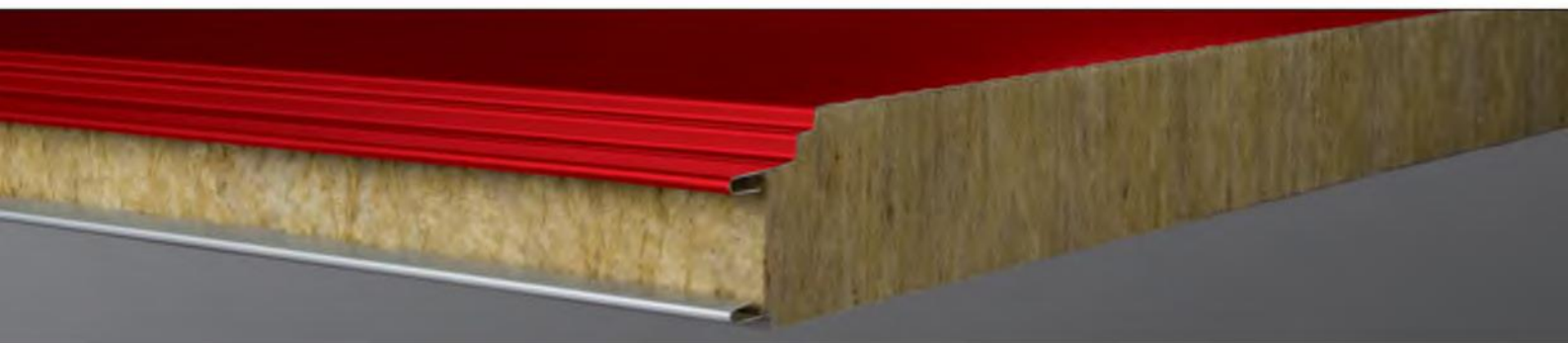

MINERAL WOOL CORE WALL SANDWICH PANELS WITH CONCEALED FASTENING



MW-W-PLUS

FEATURES

- high fire resistance - can be used as fire divisions
- **FIRESTOP** – high fire tightness - unique, both-sided shape of the panel-and-lock joint
- easy assembly - sloping of the internal joint surface, longwise groove facilitates positioning of fasteners
- **SUPERIOR GASKET** – maximum tightness of the joint and easier assembly owing to application during the production process of an EPDM gasket in internal side of the joint - **NEW!**
- compatible system - panels matching the BALEXTHERM-W-PLUS panels with various core materials
- high strength - specially prefabricated mineral wool core
- high durability of anti-corrosion coatings - appropriate technology for profiling the shape of metal facing
- aesthetic façade appearance - concealed structural joint, wide range of profiles and colours of external facing
- environment friendly - hard mineral wool is not hazardous to the natural environment

APPLICATION

- exterior walls
- partition walls
- interior flooring covering
- structure insulation
- commercial and industrial facilities of elevated fire resistance requirements
- logistic facilities
- office facilities
- agricultural facilities
- fruit and vegetable stores
- sport halls



TECHNICAL PARAMETERS

Name	Mineral wool core wall sandwich panels with concealed fastening - BALEXTHERM-MW-W-PLUS																	
Core	hard mineral wool (nominal apparent density 110 kg/m ³)																	
Facing thickness [mm]	0,50 – 0,70																	
Steel grade	S250GD																	
Coatings	SP polyester, matt pearl SP polyester, matt HDP polyester, PVC(F) „foodsaf“, PVDF, galvanized, alu-zinc + easyfilm®, CESAR PUR 55* - a polyurethane coating with polyamide balls, superior life & durability																	
Colouring	wide range of Balex Metal World of Colours – page 46																	
Panel length [mm]	2 500 - 15 000																	
Effective width [mm]	1 050									1 000								
Total width [mm]	1 100									1 050								
Core thickness [mm]	80	100	120	130	140	150	160	180	200	80	100	120	130	140	150	160	180	200
Panel weight [kg/m²]	17,79	19,80	21,90	23,00	24,00	25,01	26,10	28,20	30,30	17,10	19,20	21,30	22,40	23,40	24,50	25,50	27,60	29,70
Thermal transmittance U_c [W/m²K]	0,48	0,38	0,32	0,30*	0,28	0,26	0,24	0,22	0,20	0,48	0,38	0,32	0,30*	0,28	0,26	0,24	0,22	0,20
Fire resistance	Not spreading fire NRO (d=80); EI 30, Not spreading fire NRO (d=100); EI 60, Not spreading fire NRO (d=120)																	
Reaction to fire	A2-s2,d0																	

NEW!

* The BALEXTHERM-MW-W-PLUS panel with 130 mm thick core meets the minimal requirements related to the heat transfer coefficient for walls specified in the Ordinance of the Minister of Infrastructure

TYPES OF FACING PROFILES

L Lined



M Microprofiled



R Grooving



G Flat



AVAILABLE TYPES OF FACING PROFILES

Module 1050

Module 1000

Okładzina zewnętrzna

L M R G*

L M

Internal facing

L G*

L G*

* available with facing of minimal thickness 0.60mm

SECTIONAL VIEW OF THE BALEXTHERM-MW-W-PLUS PANEL

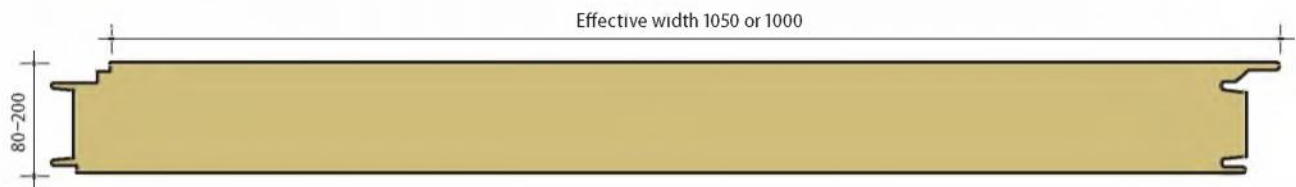

DETAILS OF THE BALEXTHERM-MW-W-PLUS PANELS JOINT

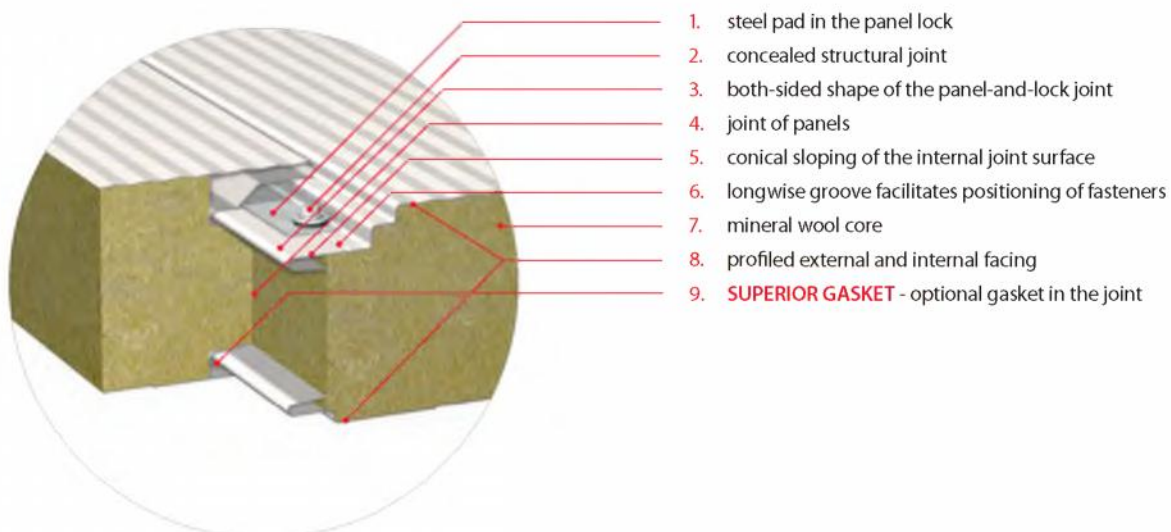



MINERAL WOOL CORE ROOF SANDWICH PANELS



MW-R

FEATURES

- **FIRESTOP** – high fire tightness - unique, both-sided shape of the panel-and-lock joint
- high thermal insulating power - tight joint
- easy assembly - clamp profiling of the lock and conical sloping of the internal joint surface matches panels with other core materials
- **SUPERIOR GASKET** – maximum tightness of the joint and easier assembly owing to application during the production process of an EPDM gasket in internal side of the joint - **NEW!**
- compatible system - panels matching the BALEXTHERM-R panels with various core materials
- high strength - mineral wool core specially prefabricated in-line
- high durability of anti-corrosion coatings - appropriate technology for profiling the shape of metal facing
- high load-bearing capacity - trapezoidal profiling of the external facing
- good drainage of rainwater
- panels of differing core thicknesses can be joined together

APPLICATION

- roof coverings
- commercial and industrial facilities of elevated fire resistance requirements
- logistic facilities
- office facilities
- agricultural facilities



TECHNICAL PARAMETERS

Name	Mineral wool core roof sandwich panels - BALEXTHERM-MW-R			
Core	hard mineral wool (nominal apparent density 110 kg/m³)			
Facing thickness [mm]	0,50 – 0,70			
Steel grade	S250GD			
Coatings	SP polyester, matt pearl SP polyester, matt HDP polyester, PVC(F) „foodsafes“, PVDF, galvanized, alu-zinc + easyfilm®, CESAR PUR 55* - a polyurethane coating with polyamide balls, superior life & durability			
Colouring	wide range of Balex Metal World of Colours – page 46			
Effective width [mm]	1 000			
Total width [mm]	1 063,50			
Panel length [mm]	2 500 – 15 000			
Core thickness [mm]	100	120	150	160
Panel weight [kg/m²]	20,30	22,40	25,60	26,60
Thermal transmittance U _c [W/m²K]	0,38	0,32	0,26	0,24
Fire resistance	NRO*	REI 90, Not spreading fire NRO		
Reaction to fire	B _{ROOF} (t _p)			
Minimal roof slope:	> 7% - for panels joined longwise or with rooflights > 5% - for continuous panels and without rooflights			

* Not spreading fire NRO

NEW!

TYPES OF FACING PROFILES

L Lined



G Flat



T Trapezoidal



AVAILABLE TYPES OF FACING PROFILES

External facing

T

Internal facing

L

G*

* available with facing of minimal thickness 0.60mm

SECTIONAL VIEW OF THE BALEXTHERM-MW-R PANEL

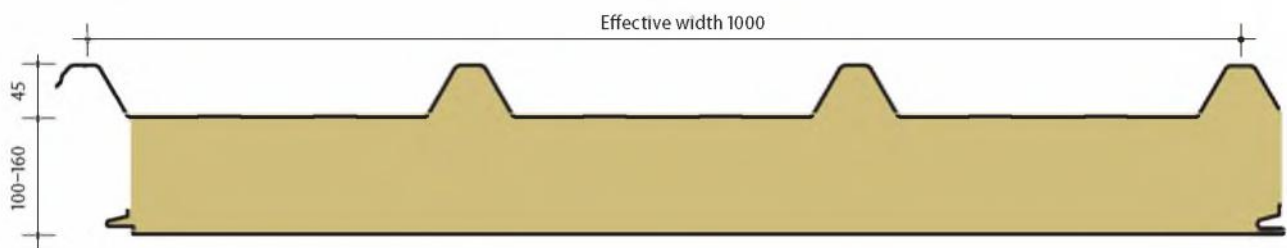

DETAILS OF THE BALEXTHERM-MW-R PANELS JOINT

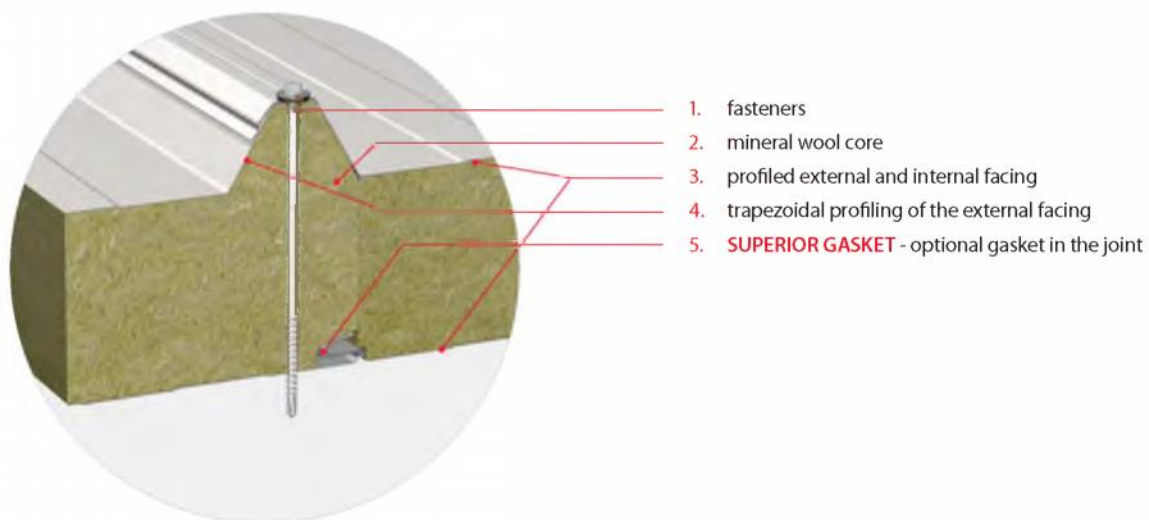

PREMIUM COATING

CESAR PUR 55® - A POLYURETHANE COATING WITH POLYAMIDE BALLS



cherry
3009



brick-red
8004



chocolate-brown
8017



silver-metallic
9006



grey-aluminium
9007



graphite
7016



black
9005



white
9010

ORGANIC COATINGS

SP POLIESTER



coral-red
3016



red
3011



red-brown
8012¹⁾



brick-red
8004



chocolate-brown
8017



signal-blue
5010



light-blue
5012



reseda-green
6011



fir-green
6020



dark-green
6005



ivory
1015



saffron-yellow
1017



signal-yellow
1003



white
9010²⁾

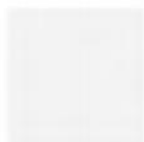

grey-white
9002¹⁾



light-grey
7035



silver-metallic
9006³⁾



grey-aluminium
9007



graphite-grey
7024¹⁾



graphite
7016³⁾



black
9005

MATT PEARL SP POLYESTER



brick-red
8620M



red
3301M



chocolate-brown
8637M



fir-green
6490M



graphite-grey
7591M



black
9005M



white
9010

PVC(F)
FOOD SAFE

MATT HDP POLYESTER



rustika
8004



malaga
1014

METALLIC COATINGS

AZ - ALU-ZINC
+ EASYFILM®



Z - ZINC



OTHER

STAINLESS
STEEL



TITANIUM
ZINC



Colours presented in the materials are only visual. Balex Metal stipulates the right to occurrence of colour differences between sample-card and actual product colour.

Presented colours available in offer of 0.50mm thick steel

1) colour available also for steel of thickness 0.60mm

2) colour available also for steel of thickness 0.60mm and 0.70 mm